

# Cast Iron Silent Check Valve • Renewable Seat and Disc • Wafer Style • Spring Actuated Class 125/250

Class 125/250

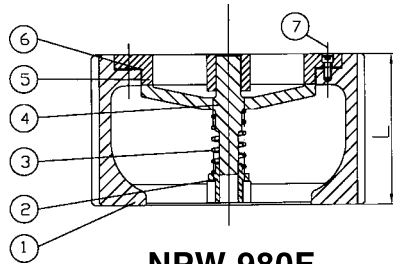

**NPW 980F**

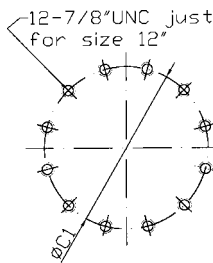
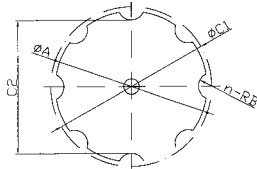

## MATERIAL LIST

PART	MATERIAL	SPECIFICATION (BS)
1. Body	Cast Iron	1561 EN JL 1030
2. Bushing	Brass	12164 CW603N
3. Spring	Stainless Steel 316	BSEN 10088-1
4. Disc	Bronze	1982 CC491K
5. Seat	Bronze	1982 CC491K
6. O-Ring	NBR	--
7. Screw	Carbon Steel	BSEN 10087

## NOTE

- Sizes 2" x 6" have dual class ratings (125lb. and 250lb.)
- Sizes 8" and above have 125lb. rating  
Class 125, 200psi / 13.8 bar non-shock cold working pressure  
Class 250, 400psi / 27.6 bar non-shock cold working pressure
- Maximum temperature to 200°F / 93°C

## DIMENSIONS (mm)

Nominal Size Inch(mm)	A	n-RB	C1	L	C2	Wt. (Kg)
2" (50mm)	111.30	4-R8	120.70	68.30	104.65	2.30
2½" (65mm)	130.30	4-R8	139.70	73.00	123.70	3.50
3" (80mm)	149.10	4-R8	152.40	81.00	136.40	5.80
4" (100mm)	181.10	8-R8	190.50	103.00	174.50	9.00
5" (125mm)	215.90	8-R9.6	215.90	97.60	196.70	12.00
6" (150mm)	250.70	8-R9.6	241.30	165.10	222.10	20.00
8" (200mm)	342.90	8-R11	298.50	165.10	276.00	39.00
10" (250mm)	406.40	8-R12	362.00	209.60	336.50	52.00
12" (300mm)	485.80	12-7/8UNC	431.80	285.80	--	87.70

USE THIS VALVE ONLY WITH FLAT FACE FLANGE AND FULL FACE BASKET.

WARNING : 1. Seal end of valve must be mated to a standard flat faced metal flange. Rubber flanges not acceptable.

2. These are not be used as steam valves.

3. Valves are not be used near a reciprocating air compressor.

4. Install 5 pipe diameters minimum downstream from pump discharge or elbows to avoid flow turbulence.

Flow straightener may be required in extreme cases.

NOTE: On pump discharge, the preferred check valves are in-line spring loaded, swing design with lever and weight or lever and spring.